

auto electrical parts

Technical Information Sheet

Part No. 0-445-75

Mini LED beacon, 12-110 volt dc with polycarbonate amber lens and 2 bolt fixing, 45 quad flashes per minute, 10 high intensity LED's. l 98 x w 72 x h 130mm. CE approved.



Technical Drawing (not to scale)

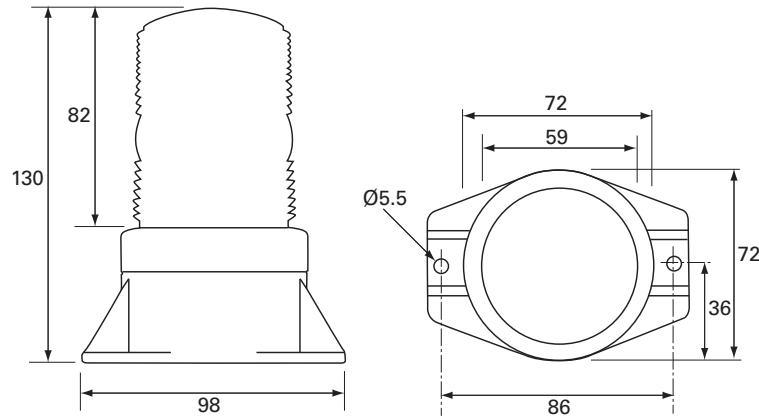

Specification

Type	LED beacon
Voltage rating	12 - 110 volt dc
Current	0.35 amp
LED	10 x 1 watt
Flash rate	45 per minute
Lens	Polycarbonate
Weight	210g
Dimensions	l 98 x w 72 x h 130mm
Compliance	CE
Protection	IP65

The information contained in this document is correct to the best of our knowledge at the time of printing. However, specifications may change at any time without notice.